

AGRILIGHT®

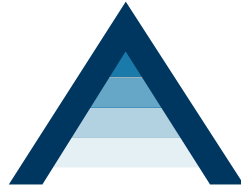

BETTER LIGHT, BETTER LIFE

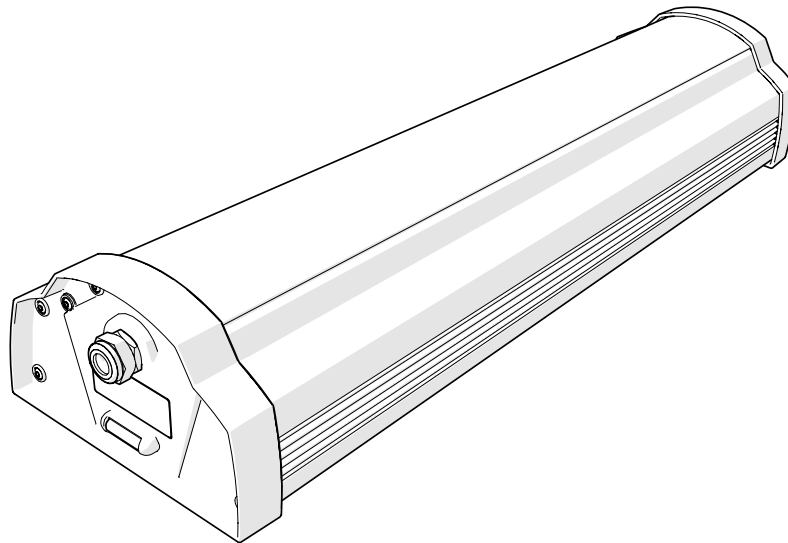

AGRILED® 3 Series Luminaire

Installation and user manual

Original manual V1.1

© Agrilight b.v. 2020-2022



Please read and understand the contents of this manual carefully. Failure to read the manual can result in serious damage, injury or death. Keep this manual. Make sure that all operators of the AGRILED® 3 Series luminaire have read and understand the contents of this manual.



Always work safe and comply with procedures, regulation and local standards.

Copyright © Agrilight b.v. 2020-2022

This language version of the manual is verified by the manufacturer (Original manual).

Agrilight b.v. reserves the right to change specifications and/or spare parts without prior notice.

The content of this manual may also be changed without prior notice.

For information about settings, maintenance and repairs not provided for in this manual, please contact the technical department of your dealer.

Agrilight b.v. accepts no liability for damage and/or problems arising from the use of spare parts not supplied by Agrilight b.v..

This manual has been compiled with all possible care. Agrilight b.v. assumes no responsibility for any errors in this manual and/or the consequences of an erroneous interpretation of the instructions.

All rights reserved. No part of this publication may be reproduced, stored in computerised databases, or made public, in any form or by any means, either electronic, mechanical, through photocopying, recording or otherwise, without the prior written consent of Agrilight b.v.. This also applies to the associated drawings and diagrams.

Preface

Thank you for purchasing the AGRILED® 3 Series. This manual is intended for the end user and installer. The manual contains all the information you need to install and use your AGRILED® 3 Series. Furthermore, the manual contains instructions for preventing possible accidents and serious harm while the product is running. Read this information carefully!

Applicable devices

This manual applies to the following devices:

- AGRILED® 3 pro red
- AGRILED® 3 pro
- AGRILED® 3 red
- AGRILED® 3
- AGRILED® 3 eco

Registration sticker

The registration sticker is attached to the AGRILED® 3 Series luminaire. Always include the type number of your luminaire when you contact your local Agrilight dealer or order spare parts. Additionally, this information can be found on the registration sticker:

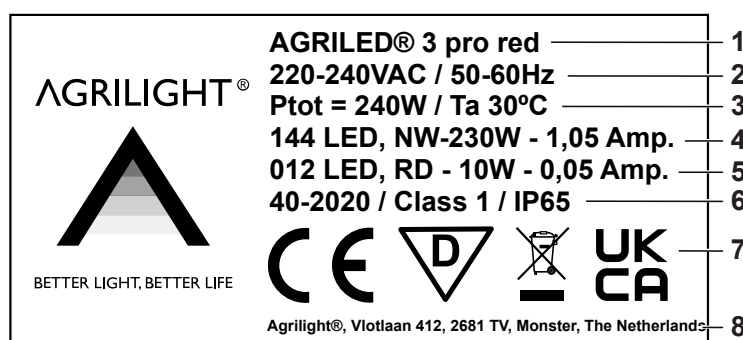

1. Product name
2. Power supply / frequency
3. Total power luminaire / maximum ambient operating temperature
4. Amount of White LEDs, NW = Neutral White - power - current
5. Amount of Red LEDs, RD = Red - power LED - current
6. Production week / year, Class 1 protection / Ingress Protection rate
7. For markings, see manual
8. Legal manufacturer

Limitations of the document

The English language version is the original version. This language version of the manual is verified by the manufacturer (Original manual). All other language versions are translations of the original English language version.

Agrilight b.v. reserves the right to modify the construction and/or configuration of its products at any time without any obligation to modify products which have been previously supplied. The

data provided in this manual is based on the most recent information. This data may be subject to change at a later date, without prior notification.

The information in this document concentrates solely on use of the product as intended by the manufacturer. In the event that the products, parts of the products or procedures are applied in any way other than that described in this manual, then confirmation must be obtained as to the correctness and suitability of that use. No rights may be derived from this manual or from the documentation supplied together with the product. The supplier is bound by no agreement other than the order confirmation.

This manual contains useful and important information on the correct operation of the product. We have taken all possible steps to make this manual as correct and as complete as possible. Should you discover any errors or omissions, please bring this to the attention of Agrilight b.v., so that we can make amendments. This will enable us to improve our documentation.

Manufacturer details

If you need any assistance, or still have questions after reading this manual, we would encourage you to contact your dealer.

We appreciate all advice, feedback and suggestions from our customers. Please contact:

Agrilight b.v.
Vlotlaan 412
2681 TV Monster
The Netherlands
+31 (0)174 287 287
info@agrilight.com
www.agrilight.com

Trademarks









All trademarks stated in this manual are registered trademarks of Agrilight b.v..

Storing the manual

The Installation and user manual is a part of your product. Store the manual in the immediate vicinity of the product. Always present a copy of the manual to operators as they work with the AGRILED® 3 Series.

Symbols used

The following marking conventions are used in this manual and on the luminaire to draw attention to specific topics or actions:

	Warns of a situation that could result in death or serious physical injury and/or may cause material damage if one does not obey the safety instructions.
	Warns of a situation that could result in minor or moderate physical injury and/or may cause material damage if one does not follow the safety instructions.
	Risk of electric shock.
	Provides additional information that is helpful to do a task or to avoid problems.
	This is the CE logo, which indicates that the product meets the legal requirements for the European Union.
	This is the UKCA logo, which indicates that the product meets the legal requirements for the United Kingdom.
	The temperature of the luminaire will not exceed 90 °C
	The symbol on the material, the accessories or packaging indicates that this product may not be treated as domestic waste.

Illustrations

It is not always possible to show the exact configuration of your luminaire. The illustrations in this manual are for description and instruction purposes only and show a regular version of the luminaire.

Recommissioning

If the product is resold, make sure this manual is always available to the buying customer.

Liability

Agrilight b.v. is not liable for any damages caused by failure to comply with the installation instructions in accordance with the legislation in your country, or any provisions assigned to function as substitutes thereof and the above assembly instructions.

Agrilight b.v. additional *General terms and conditions of sale and delivery* are exclusively applicable to all deliveries. You can also find these *General terms and conditions of sale and delivery* on our website: www.agrilight.com.

Warranty

Agrilight b.v. offers a warranty of five (5) years on the AGRILED® 3 pro red, AGRILED® 3 pro, AGRILED® 3 red and AGRILED® 3.

Agrilight b.v. offers a warranty of three (3) years on the AGRILED® 3 eco.

Refer to the *General terms and warranty conditions* for further information.

Version history

During the lifetime of the AGRILED® 3 Series, engineering improvements may result in the need to revise this manual. It is then at the discretion of Agrilight b.v., if a revision/new version of this manual is required.

The following table describes the main changes for each document version of this manual.

Version	Date	Changes
1.0	August 2020	Initial version
1.1	May 2022	Address updated, UKCA logo and DoC added

The information in this document concentrates solely on the installation and use of the AGRILED® 3 Series as intended by Agrilight b.v.. In the event that the products, parts or procedures are applied in any way other than that described in this manual, then confirmation from Agrilight b.v. must be obtained as to the correctness and suitability of that use.

Supplements to the manual

Please visit www.agrilight.com for the latest version of the manual.

Terms used

Luminaire

AGRILED® 3 Series

Installer

Person qualified to install the AGRILED® 3 Series

Contents

Preface	3
Applicable devices	3
Registration sticker	3
Limitations of the document	3
Manufacturer details	4
Trademarks	4
Storing the manual	4
Symbols used	5
Illustrations	5
Recommissioning	5
Liability	6
Warranty	6
Version history	6
Supplements to the manual	6
Terms used	6
1 Introduction	9
2 Description	10
2.1 Main components	10
2.2 Technical specifications	10
2.3 Dimensions	11
3 Safety	12
4 Transport and storage	13
5 Installation	14
5.1 Physical installation	14
5.2 Electrical installation	17
6 Commissioning	20
7 Operation	21
7.1 Operating the luminaire	21
8 Maintenance	22
8.1 Cleaning	22
9 Troubleshooting	23
9.1 Questions and Answers	23
9.2 Repair procedures	23
10 Disposal	26
11 EC Declaration of Conformity	27

12 UKCA Declaration of Conformity.....28

1 Introduction

The AGRILED® 3 Series is intended as a luminaire for lighting livestock and agricultural buildings and halls.

Any use other than the approved intended use described above is considered unintended use. Agrilight b.v. cannot be held responsible for possible (consequential) damage caused by improper, incorrect or inadvisable use.

The AGRILED® 3 Series is referred to as the "luminaire" in this manual. This manual includes all versions of the luminaire.

2 Description

2.1 Main components

The luminaire consists of the following components:

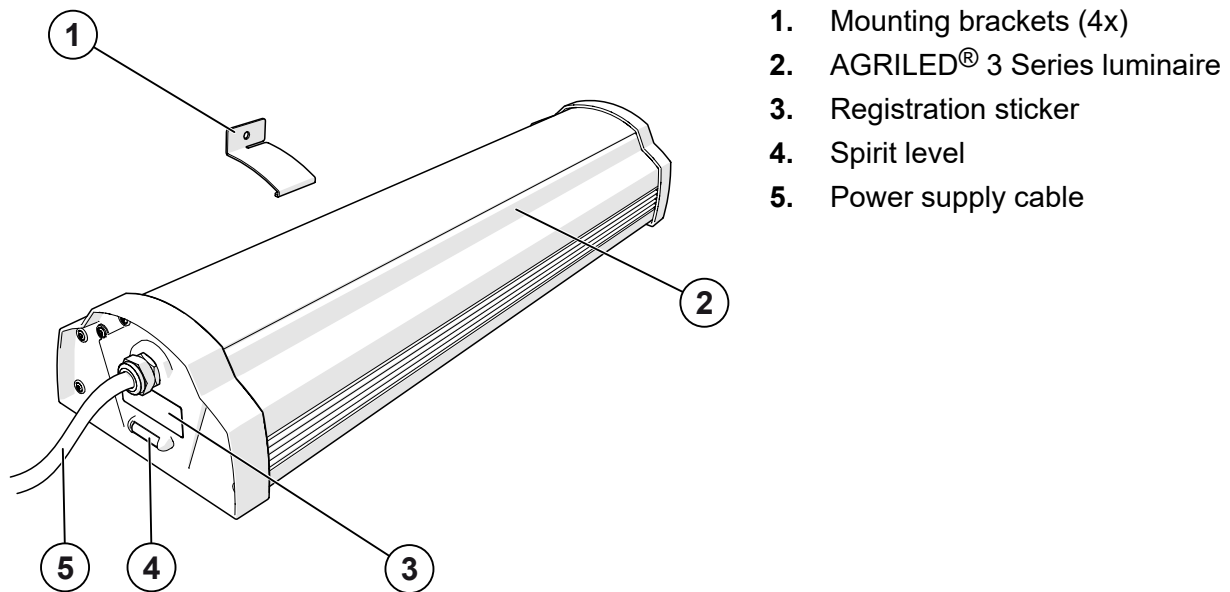

2.2 Technical specifications

	AGRILED® 3 pro red	AGRILED® 3 pro	AGRILED® 3 red	AGRILED® 3	AGRILED® 3 eco
Mains voltage	220-240V AC, 50 / 60Hz				
Input current	1,05A		0,53A		
Red LED current	0,03A		0,03A		
White LED power	240W +/- 5%		140W +/- 5%		
Red LED power	10W		10W		
Power factor	> 0,98				
Dimmable	Yes (DALI)				No
Photo biological safety	RG1				
Energy class	C				

	AGRILED® 3 pro red	AGRILED® 3 pro	AGRILED® 3 red	AGRILED® 3	AGRILED® 3 eco
Color rendering index (CRI)	70				
IP/IK rating	IP65 / IK08				
Ambient temperature	-20 °C / + 30°C				
Dimensions luminaire (L × W × H)	805 × 214 × 130mm				
Dimensions box (L × W × H)	925 × 230 × 150mm				
Weight	8,3 kg	8,3 kg	8,1 kg	8,1 kg	7,9 kg
Lifetime	100.000 L90 B50				
Warranty	5 years				3 years

2.3 Dimensions

Dimensions of the luminaire:

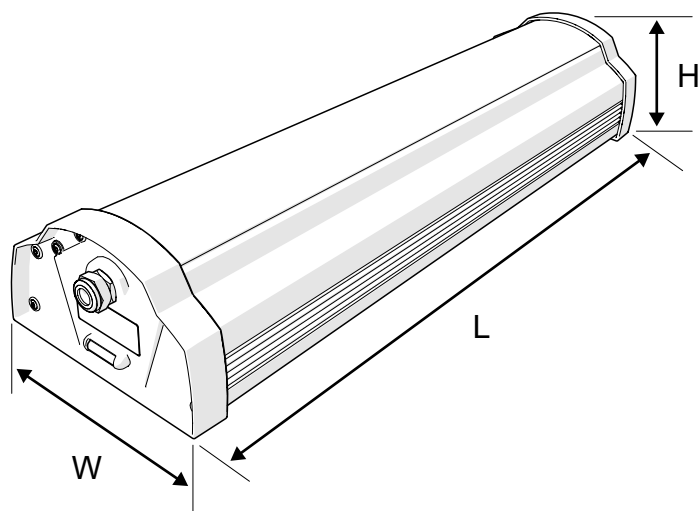

Length: 805mm
Width: 214mm
Height: 130mm

3 Safety



- The product may only be installed by an installer.
- Product installation must satisfy the current applicable standards.
- Switch off the power supply before commencing installation or maintenance work.
- Do not open or disassemble the product. Opening the product can prove hazardous and will void the warranty.
- If connected, the product or its components are powered by a 230V power supply.
- Never look directly into the light source.
- Wait at least 30 minutes after switching off the luminaire before you replace any components, e.g. the gear tray. The parts can be hot.
- Never suspend a luminaire by its power cord or power cable.
- Do not plug or unplug a lamp cord/cable while the luminaire is switched on.
- Do not plug this system into a supply voltage other than indicated on the luminaire label.



- The end user is responsible for the proper installation and product use. An incorrect installation may result in product damage or shortcomings. The warranty will become void, if the product and/or electronic components are damaged due to an incorrect installation.

4 Transport and storage

Always transport the luminaire with care, in its original packaging which is delivered with the product.

If the product is to be stored, it must be kept in a dry, clean environment with an ambient temperature between 0°C and 40°C.

5 Installation



- The product may only be installed by an installer.
- The end user is responsible for a correct and safe installation.
- Make sure that the wiring is according to the requirements as described in the specifications.
- For the electrical connection, refer to *Electrical installation* on page 17.
- Always comply with the local legal connecting conditions.

5.1 Physical installation

Gather the equipment for mounting the luminaire and consult the lighting plan before you start the installation. The luminaire can be mounted in two different ways:

1. With a roof bracket system
2. With a suspension system

Choose the correct mounting method for your situation. Both mounting systems must be ordered separately from Agrilight.



Disconnect the power.

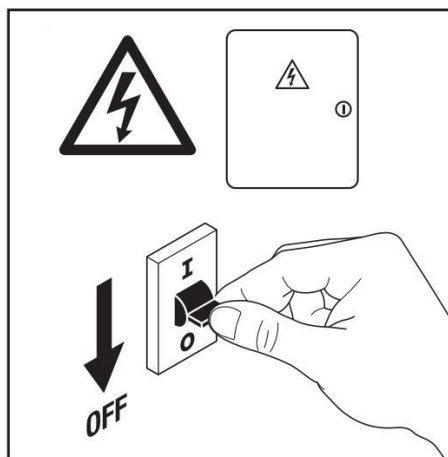

1. Remove the luminaire and brackets from the protective packaging.

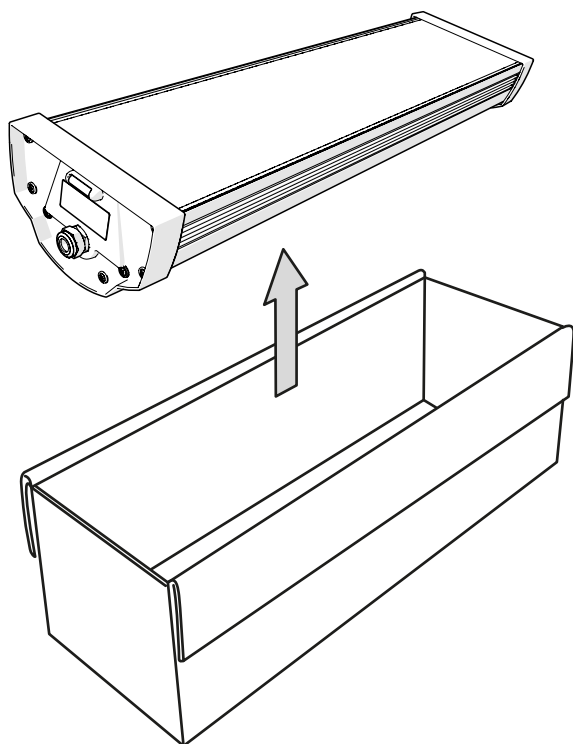

2. Mount the two sets of brackets on the luminaire and slide the brackets together. Keep a distance of 550 mm between the two sets.

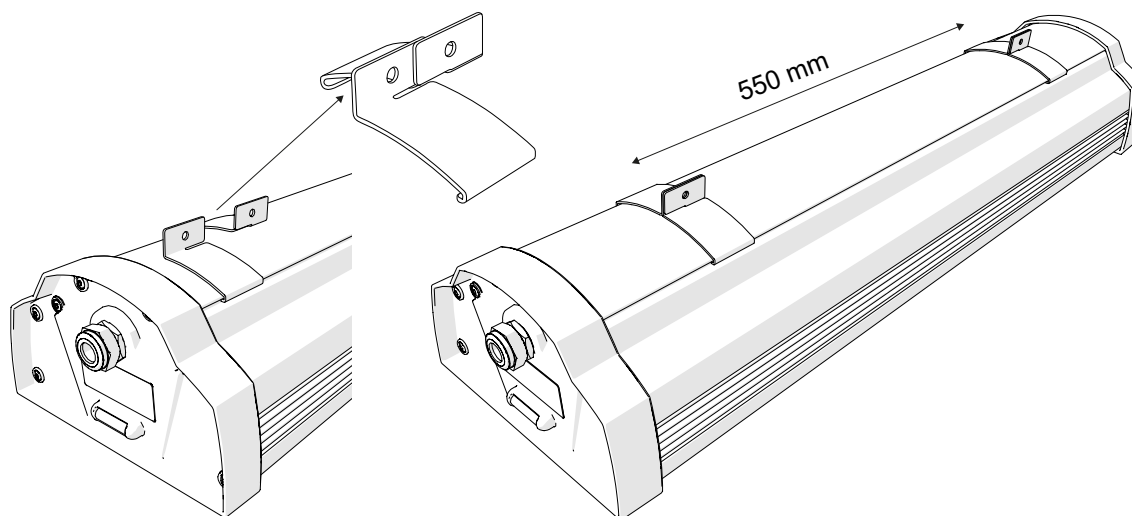

3. Mounting with suspension system

Mount the threaded ends in the centre of both bracket sets with the hardware provided. Mount the eye nuts on both sides and tighten the nuts. Mount the luminaire to the roof or ceiling using chains. (not provided).

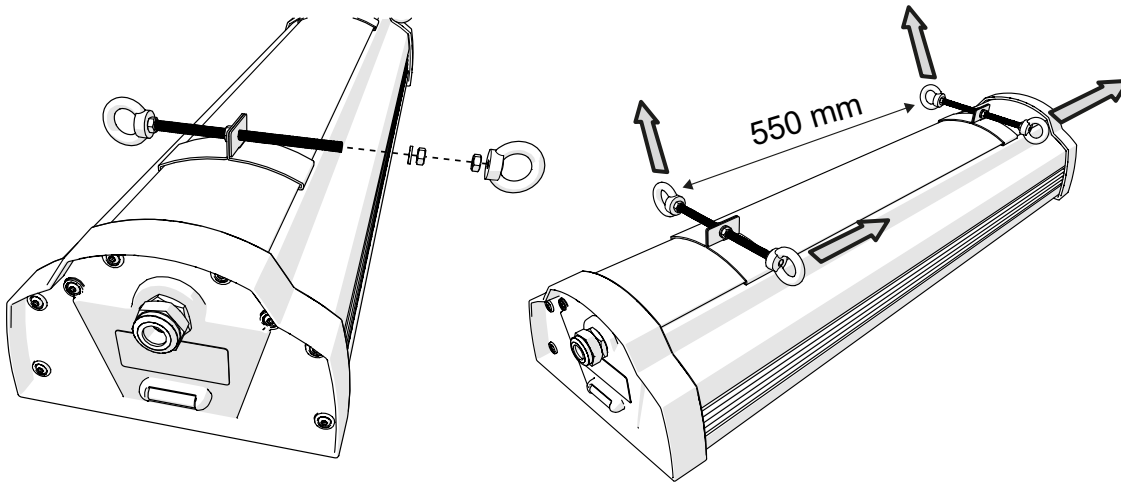

4. Mounting with a roof bracket system

- Mount the mounting strips to the brackets and tighten the bolts and nuts.
- Mount the roof bracket to the roof or ceiling.
- Mount the luminaire with strips to the roof bracket and tighten the bolts and nuts.

A+B

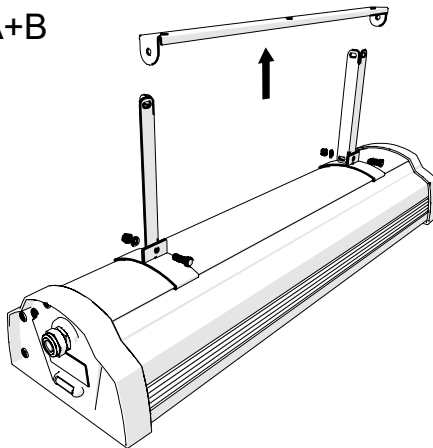

C

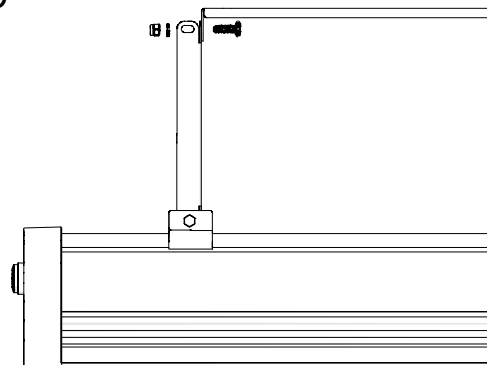

d. If necessary, connect two mounting strips together, using two extra sets of bolts, nuts and washers (not provided):

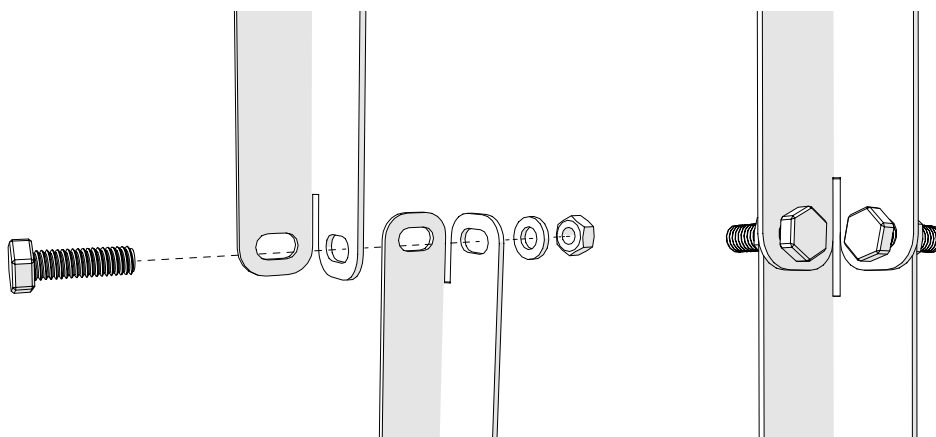

5.2 Electrical installation



To prevent water ingress, make sure there is a loop in the cable, as shown in the image below:

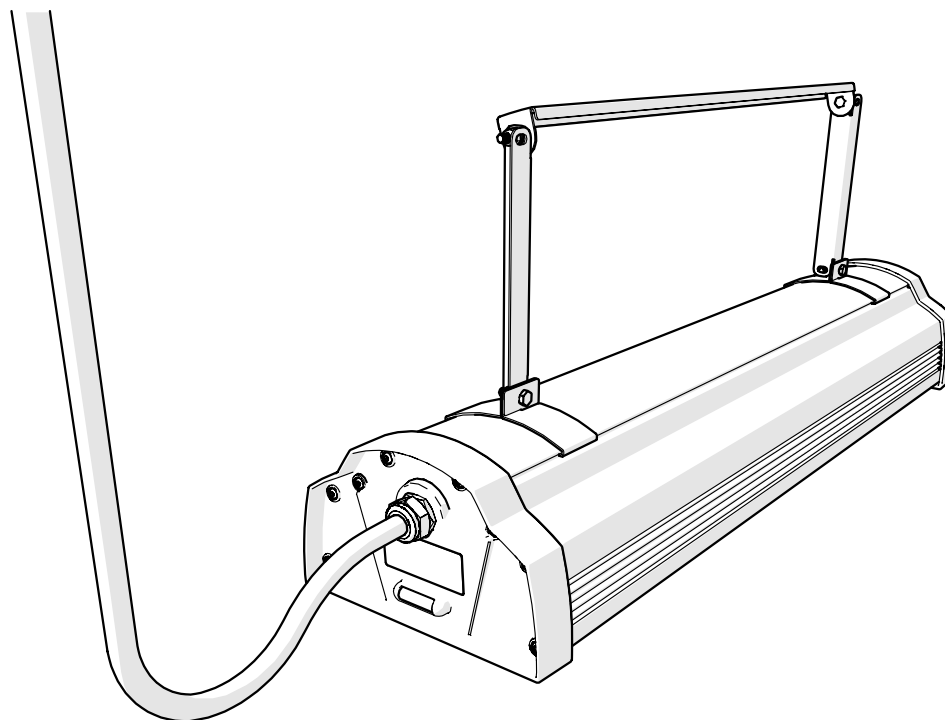

Connections 230V & Dali

Cable for AGRILED® 3 eco:



Function	Wire	Wire colour
Phase	L	Brown
Earth connection	PE	Yellow/green
Neutral	N	Blue

Cable for AGRILED® 3 and AGRILED® 3 pro:

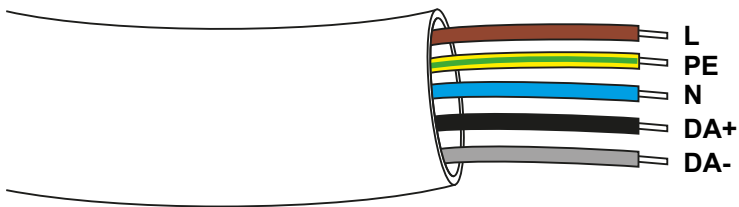

Function	Wire	Wire colour
Phase	L	Brown
Earth connection	PE	Yellow/green
Neutral	N	Blue
DALI +	DA+	Black
DALI -	DA-	Grey

Cable for AGRILED® 3 red and AGRILED® 3 pro red:

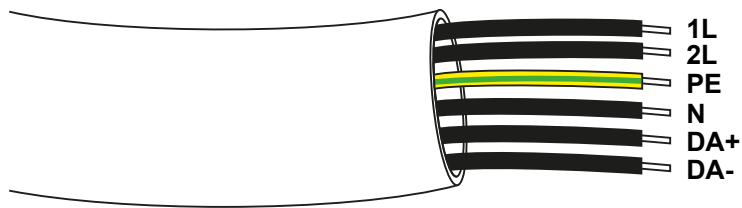

Function	Wire
Phase (white light)	1L
Phase (red light)	2L
Earth connection	PE
Neutral	N
DALI +	DA+
DALI -	DA-



The cable for AGRILED® 3 red and AGRILED® 3 pro red uses five black wires and one yellow/green wire. The wire functions are indicated on the wires.

Connections LED

Function	Connector	Wire colour
White led +	1	White
White Led -	2	Blue
Red LED +	3	Red
Red Led -	4	Black



The number of wires depends on the type of luminaire.

6 Commissioning

When all cables are connected, switch on the power supply.

Consult the DALI controller manual for information about operating the luminaire.

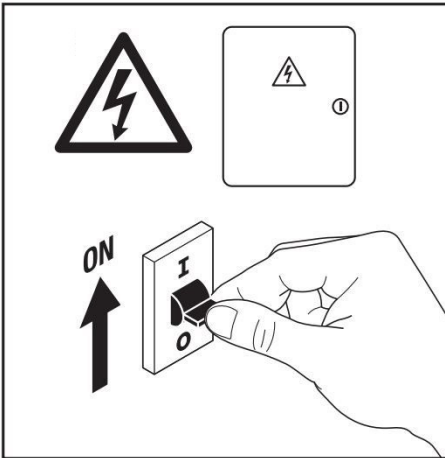

7 Operation



- The luminaire has been developed for the agricultural sector.
- When the luminaire is switched on, the ambient temperature should not exceed 86°F/30°C and the relative humidity should not exceed 70%.
- Maximum concentration NH₃ (ammonia) 20ppm.

7.1 Operating the luminaire

- The power supply 230V must be connected.
- The light level (1-100%) can be adjusted using a DALI controller.
- If no DALI controller is connected, the luminaire will switch on at 100%.

8 Maintenance



- Switch off the power supply before commencing maintenance work.
- Do not open or disassemble the product. Opening the product can prove hazardous and will void the warranty.

8.1 Cleaning

Check the product at regular intervals for build-up of dust and dirt. Clean the product, if necessary. Contamination can lead to overheating and reduce the lifetime of the luminaire.

Clean the luminaire with a dry or slightly damp cloth to keep the best light performance and lifetime.



Never clean the luminaire with corrosive cleaning agents, abrasives or other aggressive liquids.

9 Troubleshooting

9.1 Questions and Answers



- Do not replace any parts yourself. Always contact your installer for replacement parts.

Questions	Answers
1. All the luminaires do not switch on.	a. Check the mains voltage.
	b. Check the DALI controller.
	c. Check for damaged cables. If damaged, have the cable replaced by your installer.
2. One of the luminaires does not switch on.	a. Check if the cable is properly connected in the junction box.
	b. Replace the gear tray if necessary. See <i>Repair procedures</i> on page 23.
3. The luminaire(s) do(es) not operate in dimmed mode.	a. Check if the luminaire is dimmable.
	b. Check the DALI controller.
	c. Check the DALI cable connections.
If all above does not help, contact your Agrilight dealer.	

9.2 Repair procedures

When the luminaire does not function properly, please contact your Agrilight dealer. If necessary, the gear tray can be replaced by an installer. Follow these steps to replace the gear tray.

1. Disconnect the power.

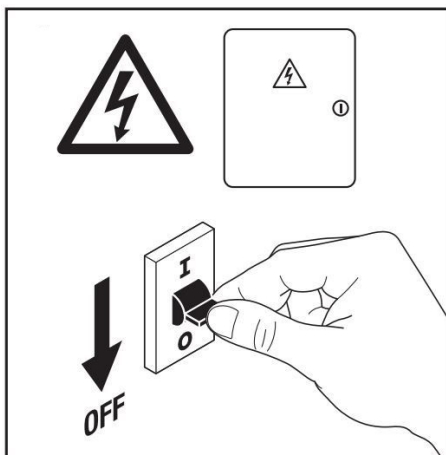

2. Unscrew the TX20 screws from the end cap with the cable by using a Torx screwdriver.

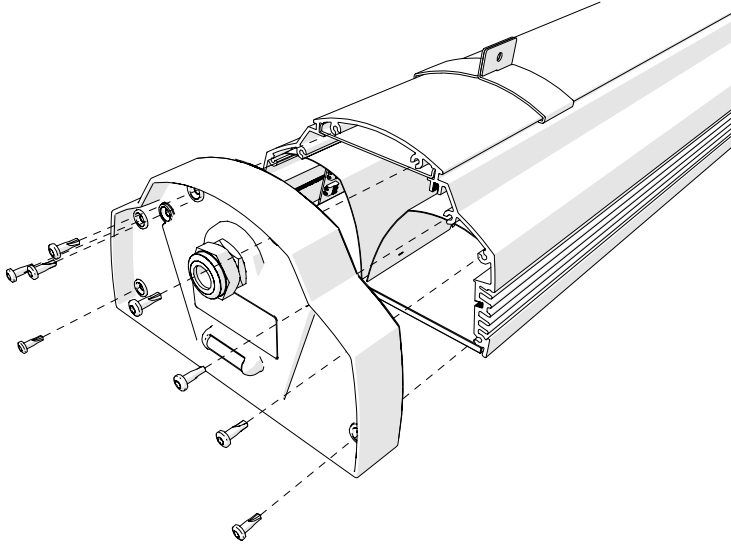

The screws may fall out of the end cap. Store the screws in a safe place.

3. Remove the end cap from the luminaire.

4. Slide out the gear tray for 150mm and disconnect the LED wires from (A) and the power supply cable from (B).

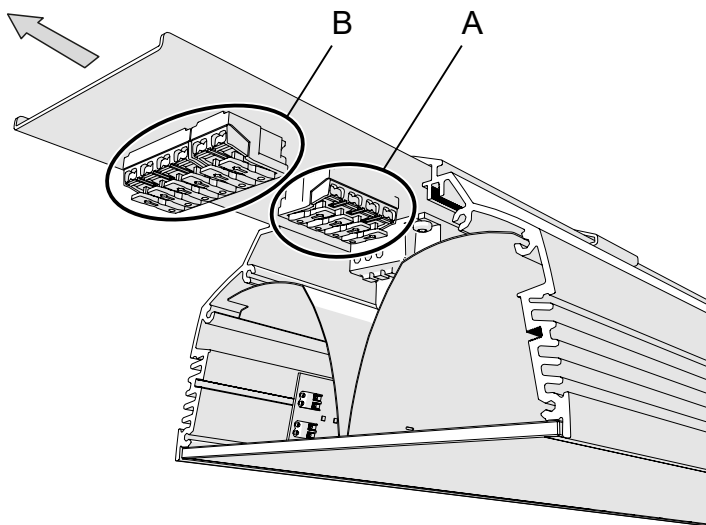

5. Remove the gear tray completely.

To install a new gear tray, follow the steps in reverse order:

- a. Reconnect the LED wires to (A). Refer to *Electrical installation* on page 17.
- b. Reconnect the power supply cable to (B). Refer to *Electrical installation* on page 17



Make sure you do not forget the earth connection.



If the luminaire does not work correctly after replacing the gear tray, contact your Agrilight dealer.

10 Disposal

Disposing this product correctly will help save valuable resources and prevent any potential negative effects on human health and the environment, which could otherwise arise from inappropriate waste handling.

Decommissioning and disassembly of the product can be dangerous and must be done only by qualified recycling organizations. All components must be disposed in compliance with the local rules and regulations. Lubricants and fluids must be disposed correctly to prevent pollution of the environment. Read the safety data sheets of the used lubricants and fluids for correct disposal. All lubricants and fluids must be disposed in compliance with the local rules and regulations.

Contact your local authority or local Agrilight service provider for further details



The WEEE-symbol (crossed-out wheelie bin) indicates separate collection of electrical waste and electronic equipment in the European countries. We are committed to being a good corporate citizen. As part of that commitment, we strive to maintain an environmentally conscious manufacturing operation. In accordance with the European Union WEEE (Waste Electrical and Electronic Equipment) Directive 2012/19/EC, we would like to notify you that this product might contain regulated materials, which upon disposal, according to the WEEE directive, require special reuse and recycling processing.

For this reason, Agrilight has arranged that this product can be recycled at the local recycling/disposal companies to collect and recycle this product at no cost to you. Additional local legislation may apply.

Please note, only this product itself is under the WEEE Directive. When disposing of packaging and other related shipping materials we encourage you to recycle these items through the normal channels. LEDs contain electronic parts and must be handed in to the appropriate authorities.

11 EC Declaration of Conformity

EC Declaration of Conformity

CE-DECLARATION OF CONFORMITY
CE-VERKLARING VAN OVEREENSTEMMING
DECLARATION DE CONFORMITÉ CE
CE-KONFORMITÄTSEKRLÄRUNG
CE-ДЕКЛАРАЦИЯ ЗА СЪОТВЕТСТВИЕ
PROHLÁŠENÍ O SHODĚ CE
EF-OVERENSSTEMMELSESEKRLÆRING
CE MĀRGIS – VASTAVUSDEKLARĀTSIOON
CE-DECLARACIÓN DE CONFORMIDAD
CE-VAATIMUSTENMUKAISUUSVAKUUTUS
CE IZJAVA O SKLADNOSTI



EK-MEGFELELŐSÉGI NYILATKOZÁS
CE-samræmisýfirýsing
DICHIARAZIONE DI CONFORMITÀ CE
EB ATITIKTIES DEKLARACIJA
CE ATBILSTĪBAS DEKLARĀCIJA
DEKLARACJA ZGODNOŚCI CE
DECLARAȚIE DE CONFORMITATE CE
FÖRSÄKRAN OM ÖVERENSSTÄMMELSE CE-MÄRKNING
VYHLÁSENIE O ZHODE CE
IZJAVA O SKLADNOSTI CE
Declaração CE de Conformidade

The undersigned, representing the following supplier,
Ondergetekende, vertegenwoordiger van de volgende leverancier
Le soussigné, représentant le fournisseur suivant
Der Unterzeichnete, den folgenden Lieferanten vertretend
Долноподписаният, представляващ следния доставчик
Niže potpisany v zastoupení následujícího dodavatele
Undertegnede, som repræsenterer nedenstående leverandør
Allakirjutanu, kes esindab alljärgnevat tarnijat
El abajo firmante, en representación del siguiente proveedor
Allekirjoittanut, joka edustaa seuraavaa toimittajaa
Dolje potpisani, kao predstavnik dobavljača

Agrilight b.v.

Vlotlaan 412

2681 TV Monster

The Netherlands

Alulirott, aki a következő beszállítót képviseli
Undirritaður sem er fulltrúi eftirfarandi birgis
La firmataria, che rappresenta il seguente fornitore
Pasirašes asmuo, atstovaujantis toliau nurodytam tiekėjui
Apakšā parakstījusies persona, kas pārstāv piegādātāju
Niżej podpisany, reprezentujący następującego dostawcę
Subsemnatul, reprezentând furnizorul următor
Undertecknad, som representerar följande leverantör
Nižšie podpísaný v zastúpení nasledujúceho dodávateľa
Podpisani predstavnik dobavitelja
O abaixo-assinado, em representação do fornecedor

Products
Producten
Produits
Produkte
Продукти
Výrobky
Produkter
tooted
Productos
Tuotteet
Proizvodi

AGRILED® 3 pro red
AGRILED® 3 pro
AGRILED® 3 red
AGRILED® 3
AGRILED® 3 eco

Termékek
Vörur
Prodotti
Gaminiai
produkti
Produkty
Produce
Produkter
Výrobky
Za naslednje izdelke
Produtos

Hereby certifies that this product is conform with the European standards.
Verklaart hierbij dat dit product voldoet aan de Europese normen
Certifie par la présente que ce produit est conforme aux normes européennes.
bestätigt hiermit, dass dieses Produkt den europäischen Normen entspricht.
С това се удостоверява, че този продукт отговаря на европейските стандарти
tímto potvrzuje, že tento výrobek je v souladu s evropskými normami
bekræfter hermed, at dette produkt er i overensstemmelse med de europæiske standarder
kinnitab käesolevaga, et see toode vastab Euroopa standarditele
Certifica por la presente que este producto satisface las normas europeas
todistada, että tämä tuote on eurooppalaisten standardien mukainen
Ovime se potvrđuje da je ovaj proizvod sukladan europskim standardima

- LVD 2014/35/EU
- EMC 2014/30/EU

Ezennel igazolja, hogy ezek a termékek megfelelnek az európai szabványoknak
Hér með vottað að þessi vara er í samræmi við evrópska staðla
Dichiara che il prodotto è conforme alle norme europee
Patvirtina, kad gaminiai atitinka Europos Sąjungos standartus
ar šio aplieciną, ka produktai atitikt Europos standartus
Niniejszym oświadczam, że produkt ten jest zgodny z normami europejskimi
Certifica que este produto está em conformidade com as normas europeias
Intygat härmed att denna produkt uppfyller kraven i de europeiska standarderna
týmto potvrzuje, že tento výrobek je v súlade s evropskými normami
Potrjujem, da je ta izdelek skladen z evropskimi standardi
Certific prin prezenta că acest produs este conform cu standardele europene

The product has been tested according to
Het product is getest overeenkomstig
Le produit ont été testé conformément à
Die Produkt wurden geprüft gemäß
Продуктът е тестван в съответствие с
Výrobek bylo testováno v souladu s
Produktet er testet i henhold til
Toodet on kontrollitud vastavalt alljärgnevale standarditele ja direktiividele
El producto han sido verificada conforme
Tuote on testattu seuraavien vaatimusten mukaisesti
Produkt testirana su sukladno

- EN 60598-1:2015
- EN 60598-2-1:1989
- EN 55015:2013 en A1:2015
- EN 61000-3-2:2014
- EN 61000-3-3:2013
- EN 61547:2009
- EN 13032-4
- IEC TR 62778
- IEC 63158
- IEC 61547-1
- EN 5509

A termék az alábbi irányelvek előírásai szerint tesztelték
Varan hefur verið prófuð samkvæmt
Il prodotto è stato testato secondo
Produkta buvo išbandyti vadovaujantis
Produkts ir testēta saskaņā ar
Produkt został przetestowany zgodnie z
Produsul a fost testat în conformitate cu
Produkten har testats i enlighet med
Výrobek bol testovaný v súlade s
Izdelek je bile preskušene skladno z naslednjimi standardi
O produto foi testados de acordo com as seguintes normas

Signature & date
Handtekening & datum
Signature & date
Unterschrift & Datum
Подпис & Дата
Podpis & datum
Underskrift & dato
Allkiri & Kuupäev
Firma & fecha
Allekirjoitus & Pvm
Potpis & Datum

H. Hondebrink
Managing Director
Agrilight

09-5-2022

Aláírás & Dátum
Undirritun & dagsetning
Firma & data
Parašas & data
Paraksts & datums
Podpis & data
Seminatura & data
Underskrift & Datum
Podpis & datum
Podpis & datum
Assinatura & data

12 UKCA Declaration of Conformity

AGRILIGHT®



BETTER LIGHT, BETTER LIFE

UKCA Declaration of Conformity



The undersigned, representing the following supplier, and technical documentation for the product(s) are available from:

Agrilight b.v.
Vlotlaan 412
2681 TV Monster
The Netherlands

Products / Modeltype

AGRILED® 3 pro red
AGRILED® 3 pro
AGRILED® 3 red
AGRILED® 3
AGRILED® 3 eco



Hereby certifies that this product is conform with the British standards.

- 2016 (SI 2016/1101) The Electrical Equipment Safety Regulations
- 2016 (SI 2016/1091) The Electromagnetic Compatibility Regulations

The product has been tested according to

- BS 60598-1:2015 - Luminaires General requirements and tests
- BS 60598-2-1:1989 - Fixed General purpose Luminaires
- BS 55015:2013 en A1:2015 - Limits and methods of measurement of radio disturbance characteristics of electrical lighting and similar equipment
- BS 61000-3-2:2014 - Limits for harmonic current emissions
- BS 61000-3-3:2013 - Electromagnetic compatibility (EMC) Limits. Limitation of voltage changes, voltage fluctuations and flicker in public low-voltage supply systems, for equipment with rated current < 16A per phase and not subject to conditional connection.
- BS 61547:2009 - Equipment for General lighting purposes. EMC immunity requirements
- BS 13032-4:2015 - Light and Lighting. Measurement and presentation of photometric data of lamps and luminaires LED lamps, modules and luminaire
- BS 62778:2014 - The assessment of blue light hazard to light sources and luminaires
- BS 63158:2018 - Equipment for general lighting purposes. Objective test method for stroboscopic effects of lighting equipment.
- BS 61547-1 - Equipment for general lighting purposes. EMC immunity requirements

Signature & date

Place of issue - Monster
Date of issue - 25/4/2022
Name - H. Hondebrink
Function - Managing Director

Signature

AGRILIGHT®



BETTER LIGHT, BETTER LIFE

Agrilight b.v.
Vlotlaan 412
2681 TV Monster
The Netherlands
+31 (0)174 287 287
www.agrilight.com
info@agrilight.com

